



Next Step To Future

XE30-Li

3.0 TON LITHIUM-ION FORKLIFT



WHY CHOOSE ME?

- ☀ Top-performing Li-ION forklift in its class.
- ☀ Includes advanced digital software for efficiency
- ☀ 4-year warranty on Li-ION battery.
- ☀ Easy maintenance with user-friendly design.
- ☀ Choose a high mast up to 6m.

Toll free Number - 1800 270 1123

Website - www.om-mh.com

MAIN CONFIGURATION SALIENT FEATURES XE30-Li



RELIABLE

- One-piece casting steering axle
- Reinforced mast and chain design
- Large tires for stability
- Efficient component layout



CONFIGURATION UPGRADES

- Standard with Li-ion heating system
- Standard with side charging port
- Standard with a colorful display
- Support to 6m high mast selection



HIGH EFFICIENCY

- KION digital controller
- KION producer JULI motor
- KION electric truck platform
- Software developed in Germany



CONVENIENT MAINTENANCE

- Simplified maintenance design
- 15% faster major parts replacement
- Premium oil, filters: cost-effective, durable
- 4-year Li-ion battery warranty



XE30-Li SPECIFICATION



Distinguishing Mark	1.1	Manufacturer		KION
	1.2	Brand		OM
	1.21	Model		XE30-Li
	1.3	Drive		Electric
	1.4	Operator type		Seated
	1.5	Rated capacity/rated load	Q(t)	3.0
	1.6	Load centre distance	c(mm)	500
	1.8	Load distance, centre of drive axle to fork	x(mm)	504
	1.9	Wheelbase	y(mm)	1785
Weight	2.1	Service weight	kg	4022
	2.2	Axle loading, laden front/rear	kg	6345/678
	2.3	Axle loading, unladen front/rear	kg	1657/2365
Tyres / Chassis	3.1	Tyres: SE=solid, P=pneumatic		PN
	3.2	Tyre size, front		28x9-15/16PR
	3.3	Tyre size, rear		6.5-10/14PR
	3.5	Wheels, number front/rear (* = driven wheels)		2x/2
	3.6	Tread, front	b10(mm)	1030
	3.7	Tread, rear	b11(mm)	953
	3.7	Tread, rear	b11(mm)	953
Basic Dimensions	4.1	Tilt of mast/fork carriage forward/backward	a/b (°)	6/10
	4.2	Height of mast, lowered	h1(mm)	2137
	4.3	Free lift	h2(mm)	150
	4.4	Lift	h3(mm)	3000
	4.5	Height of mast, extended	h4(mm)	4045
	4.7	Height of overhead guard (cabin)	h6(mm)	2230
	4.8	Height of seat/stand-on platform	h7(mm)	1195
	4.12	Coupling height	h10(mm)	725
	4.19	Overall length	l1(mm)	3819
	4.20	Length to face of forks	l2(mm)	2819
	4.21	Overall width	b1/b2 (mm)	1268
	4.22	Fork dimensions ISO 2331	sxexl(mm)	45x122x1000
	4.23	Fork carriage to ISO 2338, class/type A, B		3A
	4.24	Fork-carriage width	b3(mm)	1100
	4.31	Ground clearance, laden, below mast	m1(mm)	139
	4.32	Ground clearance, centre of wheel base	m2(mm)	168
Performance Data	5.1	Travel speed, laden/unladen	km/h	12/12
	5.2	Lift speed, laden/unladen	m/s	0.24/0.30
	5.3	Lowering speed, laden/unladen	m/s	0.37/0.40
	5.6	Max. drawbar pull, laden/unladen	N	13377/7527
	5.8	Max. gradeability, laden/unladen	%	15/15
	5.9	Acceleration time, laden/unladen	s	7.0/6.2
	5.10	Service brake		Mechanical Hydraulic
Electric Engine	6.1	Drive motor rating S2 60 min	kW	13.6
	6.2	Lift motor rating at S3 15%	kW	21
	6.3	Battery according to DIN 43531/35/36 A,B,C,no		NA
	6.4	Battery voltage/nominal capacity K5	V/Ah	80/412
	6.5	Battery weight (E)	kg	170
Misc	10.1	Operating pressure for attachments	bar	185
	10.2	Oil flow for attachments	l/min	30
	10.7	Sound pressure level at the driver's seat	dB(A)	68

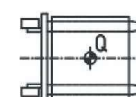
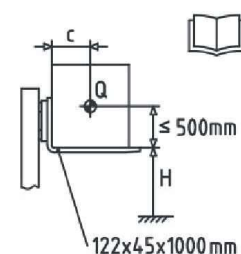

XE30-Li+S/D/T +FC

TRIPLEX MAST RESIDUAL CAPACITY CHART

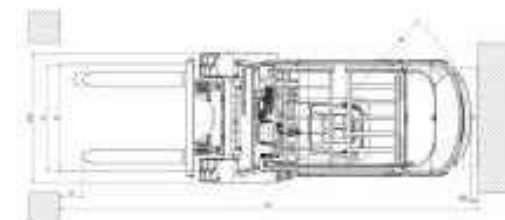
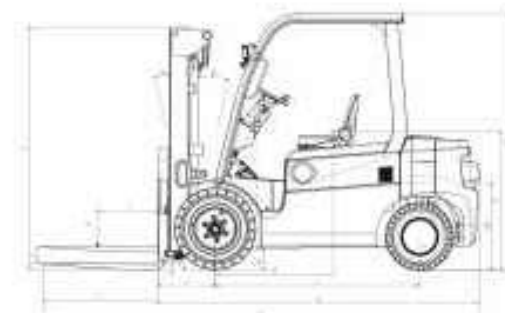
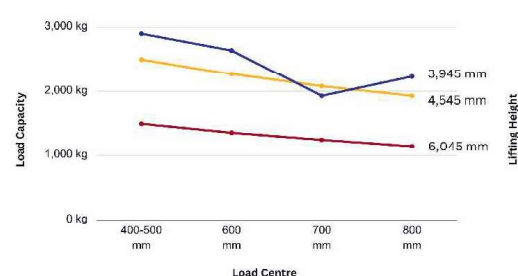

*All specifications are subject to +/-12% tolerance or as per applicable IS standards

*Safety : Truck confirms to Stability requirements as per IS standards.

*Due to continuous improvements, specifications are subject to change without prior notice

*For any other specifications required, please contact your sales representative

Mast Type	Lift Height	Retracted Height	Free Lift (with LBR)	Free Lift (without LBR)	Height of overall at max. lift (with LBR)	Height of overall at max. lift (without LBR)
Triplex Mast	h3 (mm)	h1 (mm)	h2 (mm)	h2 (mm)	h4 (mm)	h4 (mm)
	3900	2002	953	1235	4945	4652
	4500	2202	1153	1453	5545	5252
	6000	2902	1853	2153	7045	6752

MANUFACTURING



India's largest and Most Modern
Material Handling Equipment
Manufacturing Facility



Dedicated Assembly Line for MHE



Modern Paintshop



Advance Quality Testing

CUSTOMER SUPPORT

We are a dynamic team dedicated to fostering long-term engagement through our products and after-sales services. With a widespread support network across India, including remote areas, we swiftly address product queries, parts, and service needs, and offer service contracts to minimize downtime via 125+ customer touch points.

**125+ CUSTOMER
TOUCH POINTS
FOR SALE AND SERVICE**



OM BRAND HERITAGE



Founded in 1917 with an initial focus on automobiles and later expanding into forklift trucks in 1937, OM joined forces with the KION Group in 2006. Since its introduction to the Indian market in 2017, OM products have risen to prominence as the preferred option for material handling equipment.



Address: KION India Private Limited, Gat No. 134/1, Vadhu Road,
Off Pune Nagar Road, Koregaon Bhima, Taluka Shirur, District Pune 412216.

Email: in.enquiries@kiongroup.com | Website: www.om-mh.com

TOLL FREE NUMBER- 1800 270 1123

OCTOBER 2023